

# AD Range, PG Range & TOC 1500

## Installation Guide

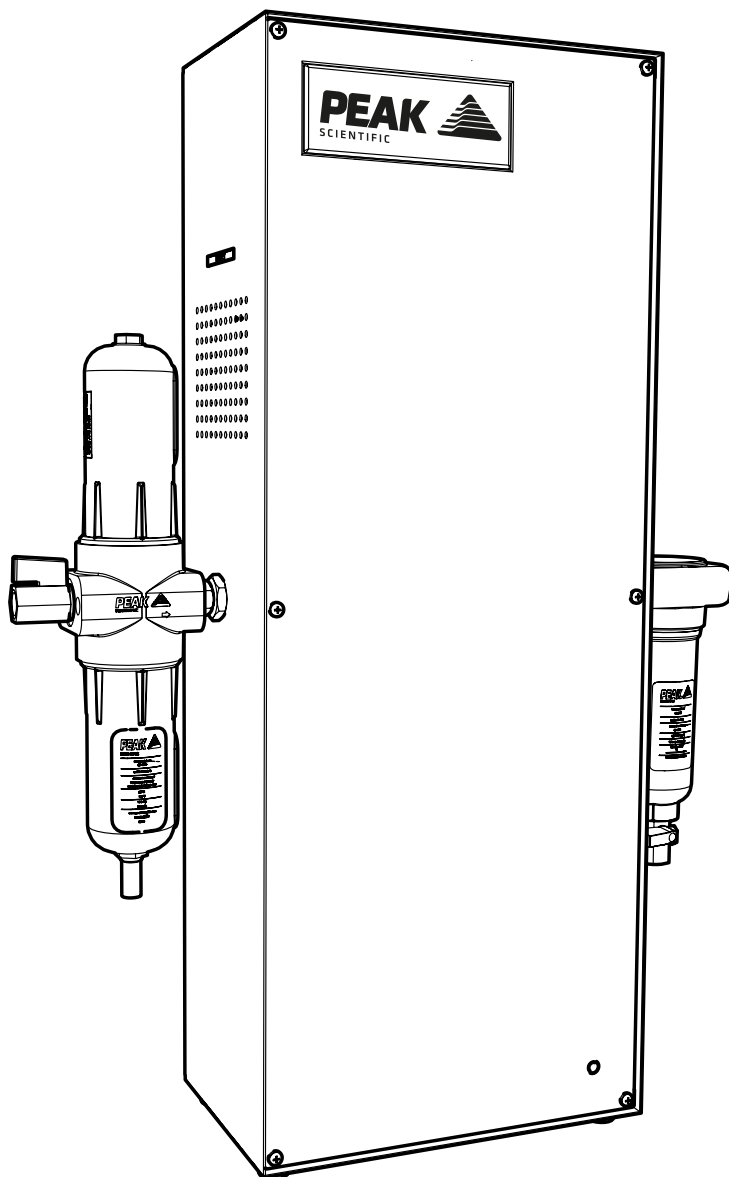

## Change History

Rev	Comment	Name	Date
1	Initial Release	L. Couttie	03/11/2017
2	Wall Mount Image Update	L. Couttie	24/01/2019

## How to use this Installation Guide

This document is intended to be used only as a Quick Start Guide, to facilitate safe and correct installation and initial configuration of your Peak Scientific gas generator.

For more extensive user operation directions, we recommend you download the User Manual from the website.

**Please visit [www.peakscientific.com/downloads](http://www.peakscientific.com/downloads) to download the full User Manual for your gas generator.**



Thank you for selecting Peak Scientific to meet your laboratory gas generation needs, and should you require any further assistance or support please do not hesitate to contact Peak Scientific or Peak Partner from which you purchased your generator.

# Safety Notices

Peak Scientific Instruments cannot anticipate every possible circumstance which may represent a potential hazard. The warnings detailed within this document detail the most known potential hazards, but by definition cannot be all inclusive. If the user employs an operating procedure, item of equipment or a method of working which is not specifically recommended by Peak Scientific, the user must ensure that the equipment will not be damaged or become hazardous to persons or property.

## Symbols

This document uses the following symbols to highlight specific areas important to the safe and proper use of the Generator

 WARNING	A WARNING notice denotes a hazard. It calls attention to an operating procedure, process or similar, which if not correctly performed or adhered to, could cause personal injury or in the worst case death. Do not proceed beyond a WARNING notice until the indicated conditions are fully understood or met.
 CAUTION	A CAUTION notice denotes a hazard. It calls attention to an operating procedure, process or similar, which if not correctly performed or adhered to, could cause damage to the Generator or the Application. Do not proceed beyond a CAUTION notice until the indicated conditions are fully understood or met.
	Caution, risk of electric shock. Ensure power to the Generator has been removed before proceeding.

## Safety Notice to Users



These instructions must be read thoroughly and understood before installation and operation of your Peak Generator. Use of the generator in a manner not specified by Peak Scientific MAY impair the SAFETY provided by the equipment.



When handling, operating or carrying out any maintenance, personnel must employ safe engineering practices and observe all relevant local health and safety requirements and regulations. The attention of UK users is drawn to the Health and Safety at Work Act 1974, and the Institute of Electrical Engineers regulations.



If the equipment is used in a manner not specified by the manufacturer, the protection provided by the equipment may be impaired.

# Fittings Kit

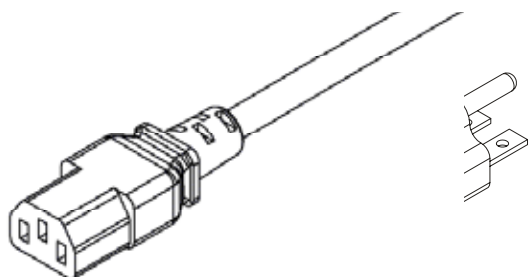

**x1**

US Mains Cable C13 6-15 04-1029

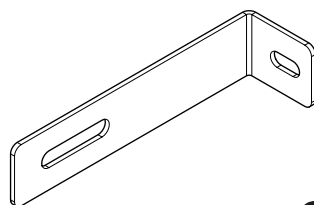

**x2**

Wall Bracket 06-6341

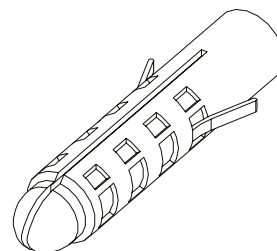

**x4**

No. 8 Wall Plug 00-4076

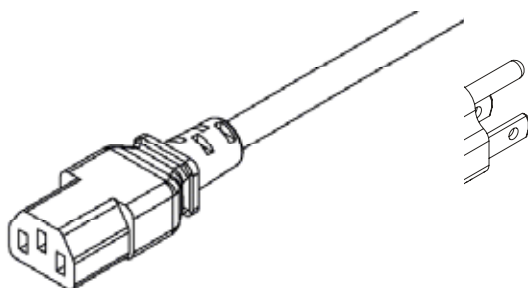

**x1**

US Mains Cable C13 5-15 04-1039

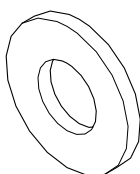

**x2**

Plain Washer 00-1034



**x3m**

6mm OD Teflon 00-1302

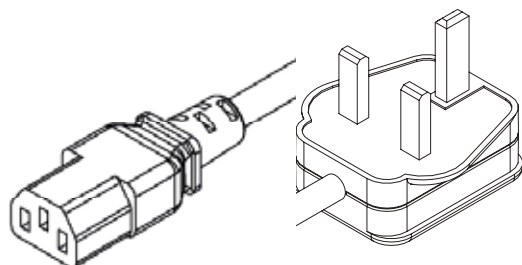

**x1**

UK Mains Cable C13 04-1030



**x2**

Shakeproof Washer 00-1036

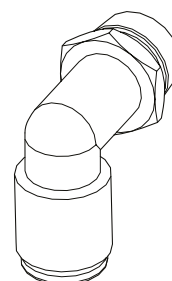

**x2**

1/4" - 6mm Push Fit Elbow Fitting 02-4331

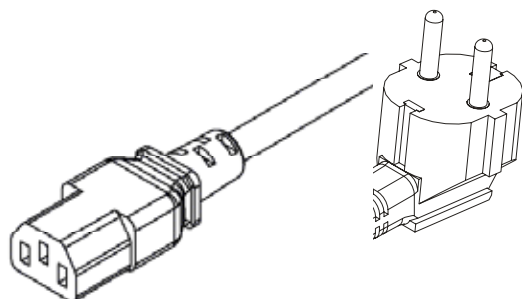

**x1**

EU Mains Cable C13 04-1038

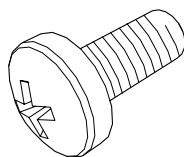

**x2**

M4 Screw 00-3008

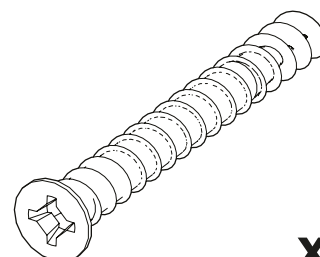

**x4**

No. 8 Screw 00-4075

1.

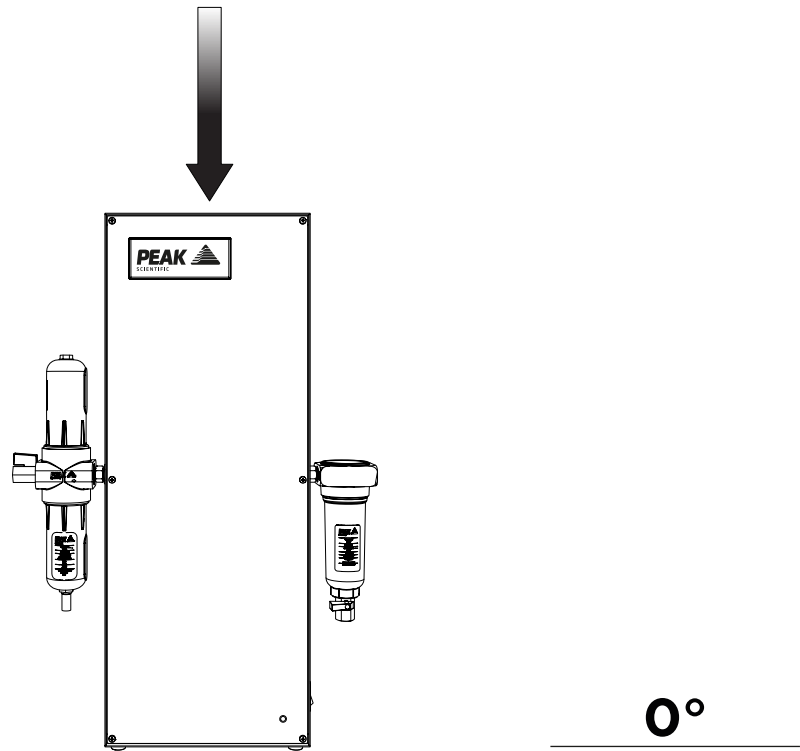

Unpack the generator from the shipping crate and position on a flat surface, in desired area.

2.

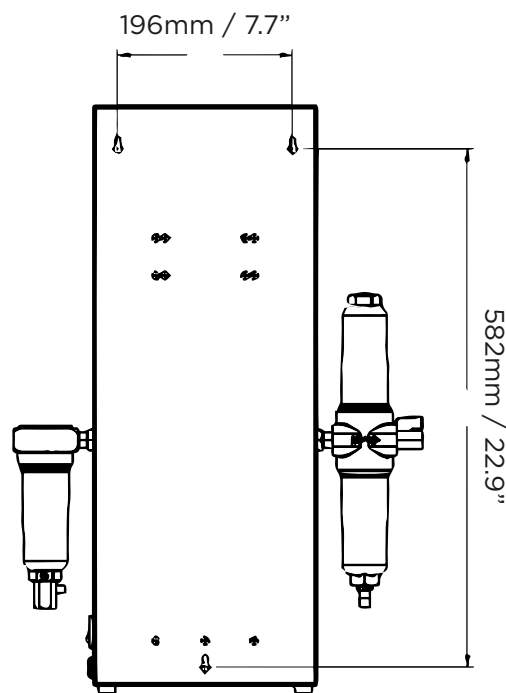

The generator can be wall mounted, **If do not wish to wall mount your generator proceed to step 4.**

The measurements for the **3 mounting holes** shown on the image differ between models. Consult the **Wall Mounting Section** on page 11 for the correct dimensions for your model, and use these to drill holes to fit the wall plugs and screws provided.

Please ensure the wall plugs are suitable for the surface the generator is being fixed to.

3.

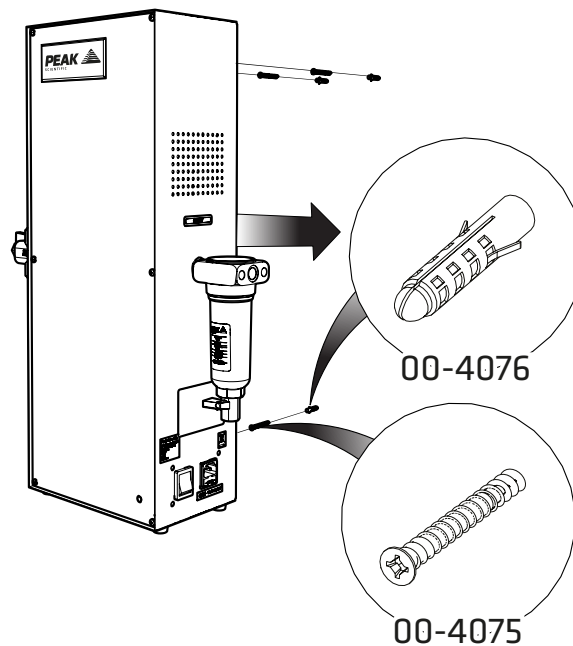

With the holes drilled in your desired location, fit the 3 x **No. 8 Wall Plug 00-4076** and 3 x **No. 8 Screw 00-4075** to the wall and mount your generator onto them.

4.

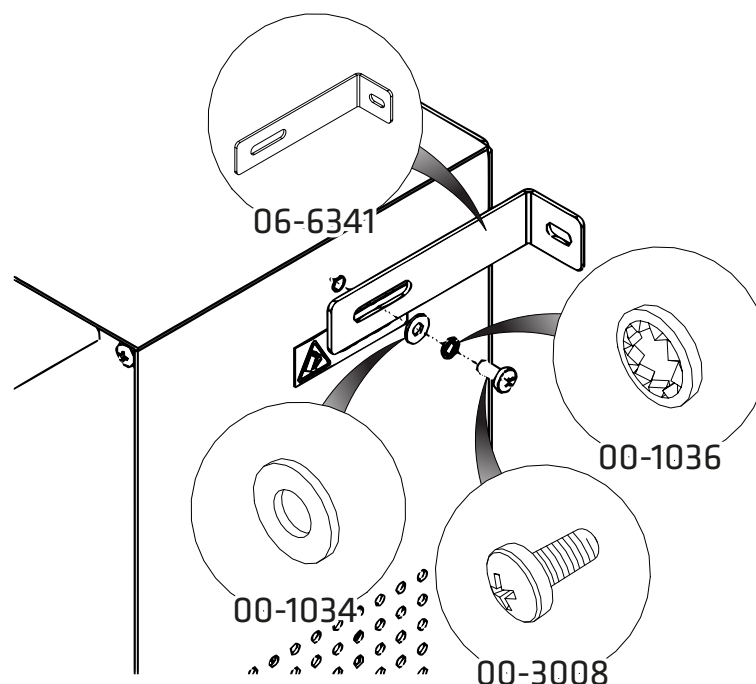

If the generator is not wall mounted using the key slots in the rear face, it must be fixed to the wall using the brackets provided for safety reasons.

Locate the threaded holes on the right and left side of the generator, beside the yellow warning labels.

Use the screw, shake proof washer and plain washer provided to attach the bracket to the side of the generator.

5.

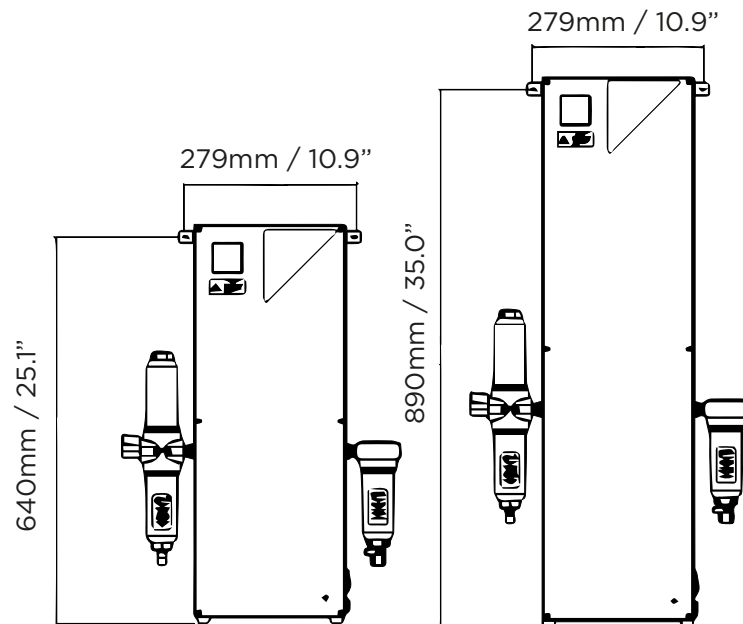

Finally, using the dimensions provided, fix the wall plugs to the wall, ensuring that the wall plugs provided are suitable for the type of wall in question. Secure the generator to the wall with the screws from the fittings kit.

6.

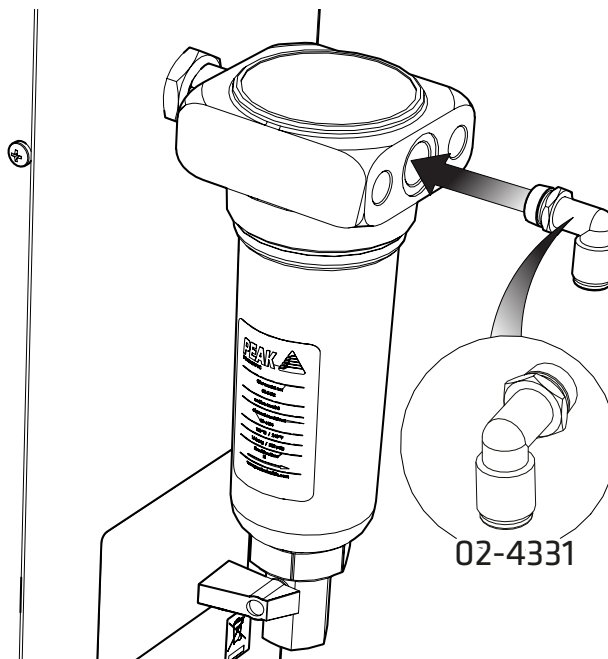

Select the **1/4" - 6mm Push Fit Elbow Fitting 02-4331** and attach it to the filter outlet on the right side of the generator. It is recommended that PTFE tape is applied to the threads to ensure a leak-tight fit.

7.

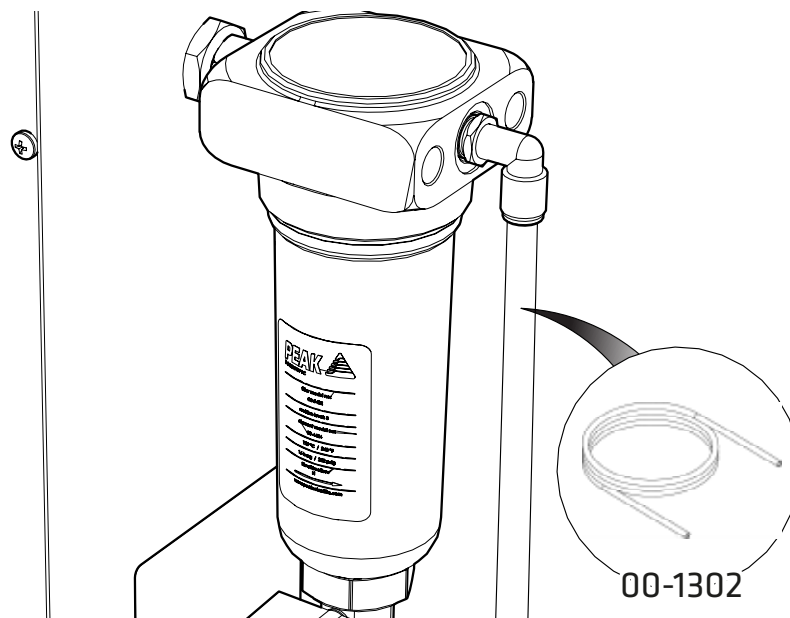

Attach the supplied **6mm OD Teflon 00-1302** and connect this to the **1/4" - 6mm Push Fit Elbow Fitting 02-4331**.

Connect the other end to your instrument's gas input.

8.

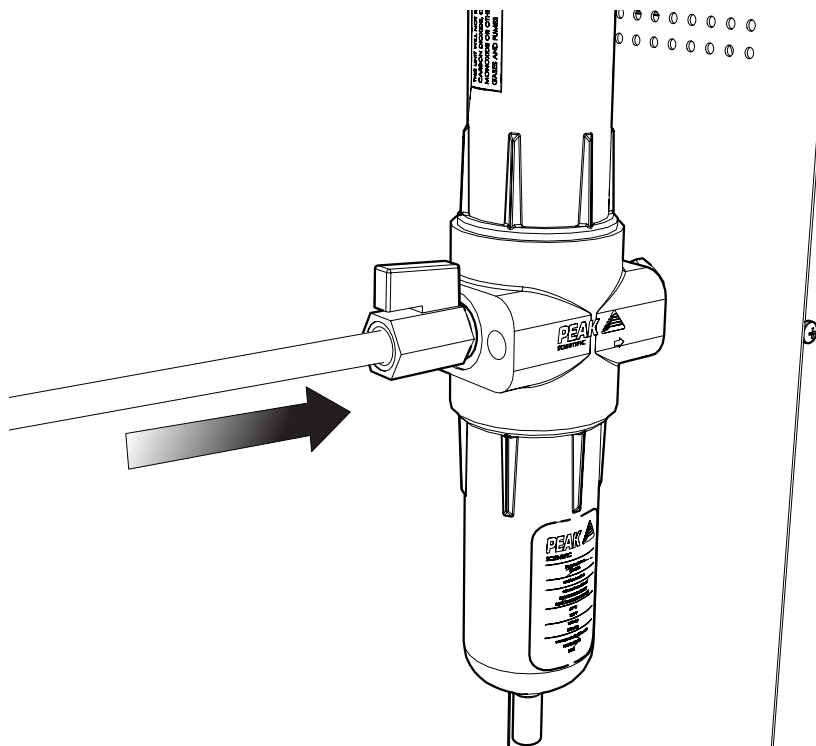

Attach your house air supply to the **BA filter** at the **left side** of the generator. Ensure the valve on the filter is at the **open** position.

9.

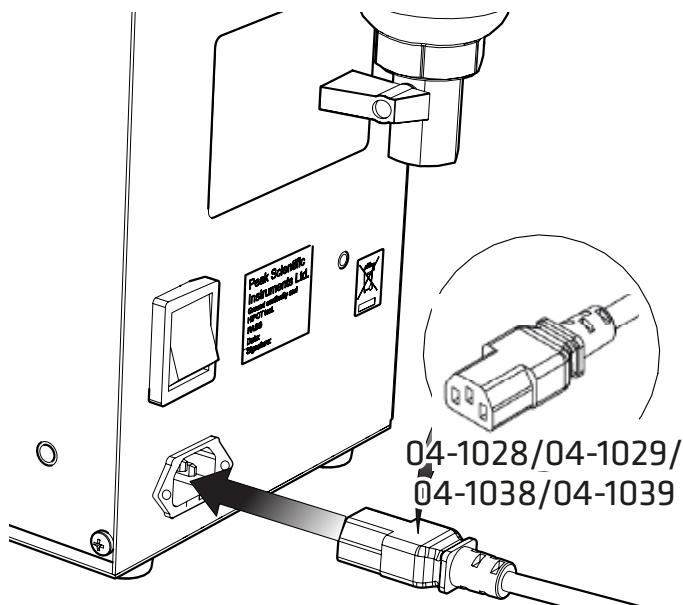

Select the appropriate **mains cable** from the fittings kit and plug the **IEC 60320/C19** cable into the **mains input** at the side of the generator.

10.

UK

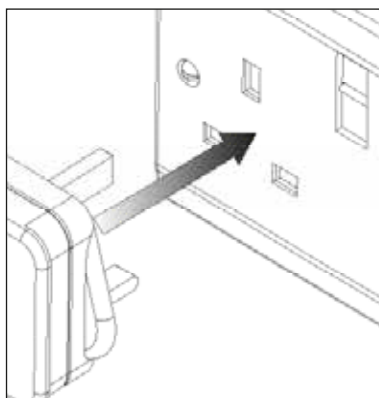

EU

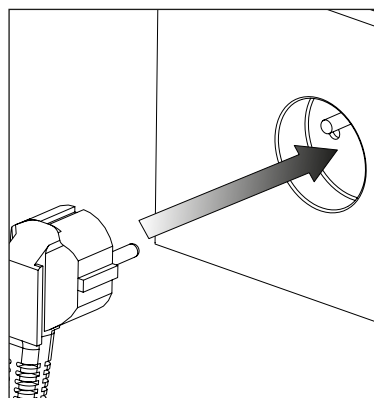

US  
110V

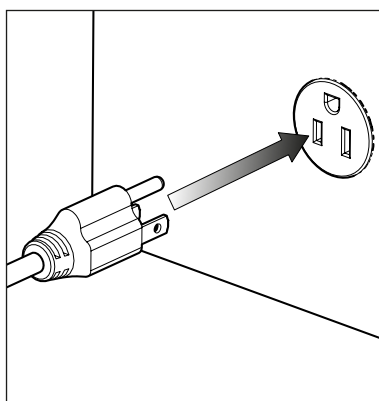

US  
230V

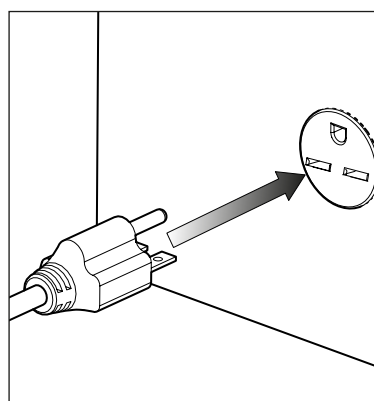

Plug the mains cable into the corresponding **110VAC 60Hz OR 230VAC 50/60Hz** single phase power supply.

**CAUTION** ensure the correct cable has been selected for your electrical supply.

Consult the **Electrical Requirements** section if you are unsure of the requirements of your generator.

11.

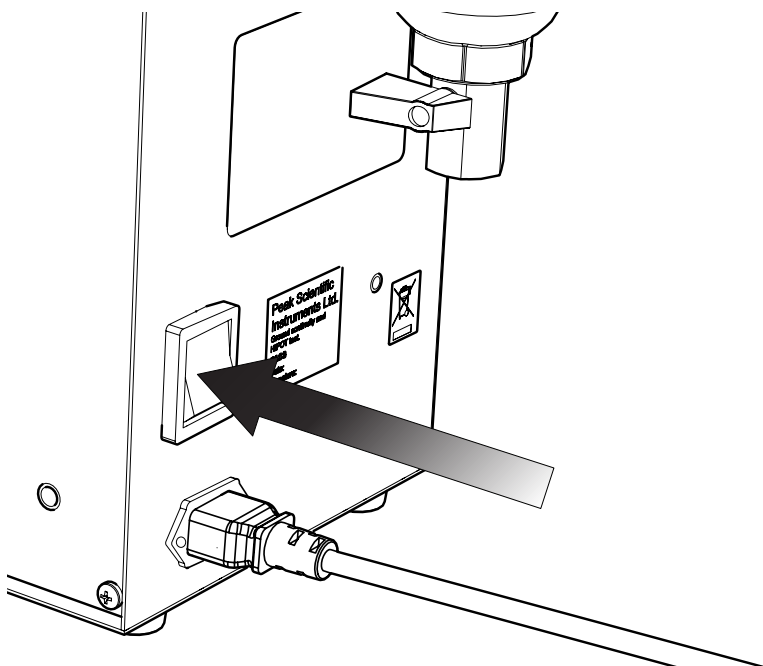

Switch the generator **ON**, using the **switch at the side** of the generator.

12.

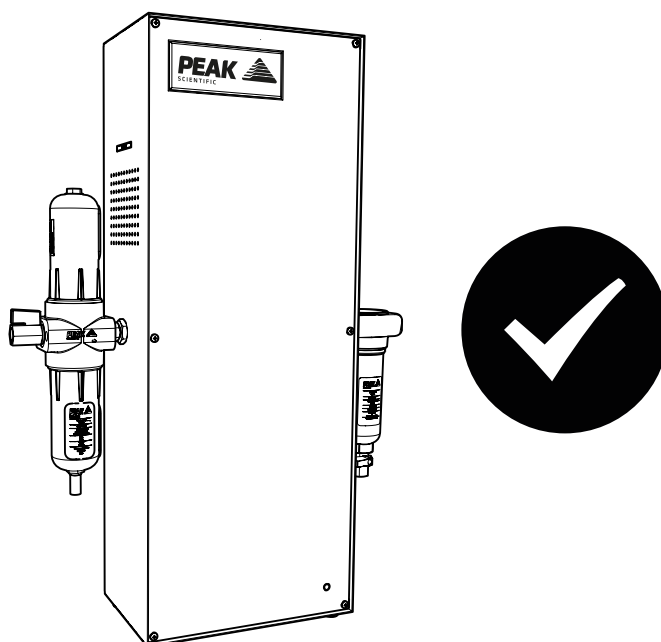

## CONGRATULATIONS

Your **Peak Scientific** gas generator is now fully installed, operational and ready to supply gas on demand to your instrument.

## General Notes

- The 3m length of Teflon tube supplied in the fittings kit is to allow the generator to be installed adjacent to the instrument it is supplying. If the generator is to be installed further away from the instrument then attention needs to be paid to pressure drops that could occur. The maximum distance away from the instrument the generator can be placed still using 6mm (4mm internal diameter) or ¼" (3/16" internal diameter) tubing is 10m. For further information relating to tubing lengths please refer to the user manual.

## Electrical Requirements

Generator	Voltage		Frequency		Plug Type
	230	110	50	60	
AD Range	✓	✓	✓	✓	UK, EU, US 230V, US 110V
PG Range	✓	✓	✓	✓	UK, EU, US 230V, US 110V
TOC 1500	✓	✓	✓	✓	UK, EU, US 230V, US 110V

## Wall Mounting

Generator	Distance between top mounts	Distance from top to bottom mount
AD 70L, 140L PG 14L TOC 1500	196 mm / 7.7 Inches	582 mm / 22.9 Inches
AD 302L PG 28L	100 mm / 3.9 Inches	840 mm / 33.0 Inches
AD 1010L	100 mm / 3.9 Inches	945 mm / 37.2 Inches

Please familiarise yourself with the full **User Manual** available at [www.peakscientific.com/downloads](http://www.peakscientific.com/downloads). This includes all other technical specifications, operating instructions, service requirements, contact details and trouble shooting.

# Go Online or Complete and Return

We know that registering any of your recently purchased products is not the first thing on your mind- but it is very important to both of us. Not all warranties are alike and Peak Scientific stand out against other gas suppliers as we offer a comprehensive, quick response, on-site warranty. This means that in the very unlikely case that your gas generator develops a fault we have rapid support teams on-hand around the world who are able to come to your lab and get you back up and running in no time.

Register for your **comprehensive 12 month on-site warranty** with ease online at [www.peakscientific.com/register](http://www.peakscientific.com/register).

Alternatively, you can send the completed form to Peak Scientific by post or email at [warranty@peakscientific.com](mailto:warranty@peakscientific.com).

**Go Online or Complete and Return**

You can register for your **FREE 12 month Warranty** with ease online at [www.peakscientific.com/protected](http://www.peakscientific.com/protected).

Alternatively, you can send the completed form to Peak Scientific by post or email at [warranty@peakscientific.com](mailto:warranty@peakscientific.com).

Product Warranty Registration			
Contact name			
Email address			
Company			
Address			
City/town			
Postcode			
Country			
Telephone			
Generator serial #			
Model type			
Installation date			
Do you still use an alternative gas solution i.e. cylinders or bulk liquid?	Yes	No	
What gas requirements do you have in your lab?	Hydrogen	Nitrogen	Zero Air

**Extend your cover with**

Peak Scientific offer comprehensive gas generator after sales support packages. Peak [Protected] aftercare support can guarantee an on-site response within 72 hours\*, genuine parts from our ISO9001 approved factory and a 95% first-time fix rate. See our enclosed Peak [Protected] leaflet for further information.

**Important!**

You have 1 month to register your Peak Scientific product from the date of installation. Once registered the warranty will be honoured for a period of 12 months. If you wish to defer the installation of your generator, you must notify Peak Scientific immediately by emailing [warranty@peakscientific.com](mailto:warranty@peakscientific.com). For generators that remain unregistered after 1 month from the shipment date, the warranty will be considered active from the date of factory dispatch.

\* Complete Plan only

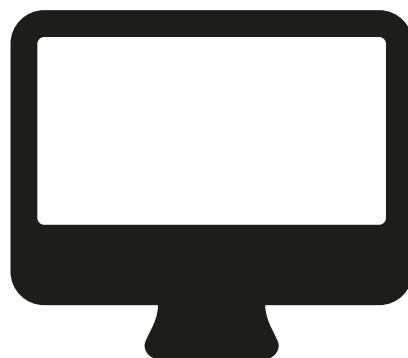

## Important!

You have **1 month to register** your Peak Scientific product from the date of installation. Once registered the warranty will be honoured for a period of 12 months. If you wish to defer the installation of your generator, you must notify Peak Scientific immediately by emailing **[warranty@peakscientific.com](mailto:warranty@peakscientific.com)**. For generators that remain unregistered after 1 month from the shipment date, the warranty will be considered active from the date of factory dispatch.







Please visit [www.peakscientific.com/downloads](http://www.peakscientific.com/downloads) to download the full User Manual for your gas generator.

## [**PEAK Protected**]<sup>TM</sup>

Peak Scientific has highly trained, fully certified Field Service Engineers located in over 20 countries across every continent around the world. This allows us to provide an industry-leading rapid response service to our customers. With [**Peak Protected**], your laboratory's productivity becomes our top priority.

To discuss Peak Protected generator cover and payment options speak to your local Peak Representative or for further information contact: [protected@peakscientific.com](mailto:protected@peakscientific.com).

### **Peak Scientific**

Fountain Crescent  
Inchinnan Business Park  
Inchinnan  
PA4 9RE  
Scotland, UK  
**Tel:** +44 141 812 8100  
**Fax:** +44 141 812 8200

For further information on any of our generator products please contact [discover@peakscientific.com](mailto:discover@peakscientific.com)